

# CORNER RESTORATION

E  $\frac{1}{4}$  cor.  
CORNER Sec. 19 TWP 13 S. RANGE 30 E.

ORIGINAL SURVEY BY: John B. David

CONTRACT NUMBER: 131

CONTRACT DATE: June 8, 1869

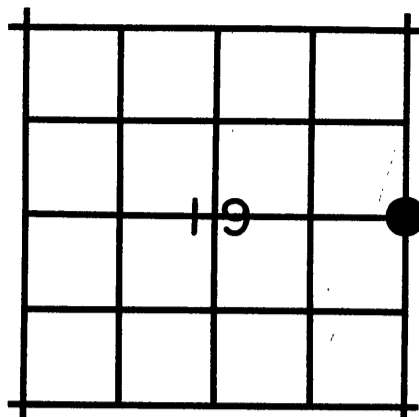

## ORIGINAL DESCRIPTION:

North between Sections 19 and 20

Set stone 18x14x10 for  $\frac{1}{4}$  section corner

## RESTORATION BY, STAMP AND DATE:

R. D. Bagett  
M. D. Bagett  
J. L. Watson

REGISTERED  
PROFESSIONAL  
LAND SURVEYOR

OREGON  
JULY 12, 1963  
ROBERT D. BAGETT  
598

July 7, 1986

Grant County Surveyor

## EVIDENCE FOUND:

Found original corner monument, a basalt stone 18x12x9 inches, marked  $\frac{1}{4}$ .

## DESCRIPTION OF MONUMENTS AND ACCESSORIES SET AND METHODS USED:

Show how trees are scribed and basis of bearings, including compass var.

At the position of the original corner stone, I set a 1 $\frac{1}{2}$ "x30" iron pipe 10 inches in the ground with attached brass cap marked as shown. I buried cor. stone North and alongside.

Built a mound of stone 4 ft. base to top of cap. From which I set reference monuments:

A 5/8"x30" iron pin bears N. 49° E., 25.0 ft.  
with attached yellow plastic cap marked "B-G-A Survey Marker"  
A 5/8"x30 inch iron pin bears N. 59° W., 25.0 ft.  
with attached yellow plastic cap marked "B-G-A Survey Marker".

Used a magnetic compass with 18° E. var. and steel tape.  
Corner falls 1.0 ft. West of a North-South fence line.

## MONUMENT MARKED

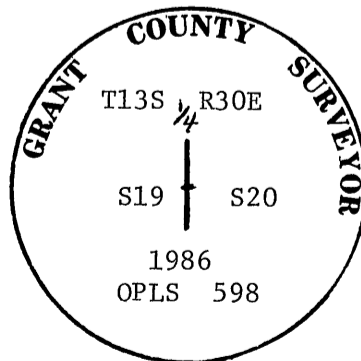

RECEIVED AND  
FILED

AUG 15 1986

OFFICE OF COUNTY SURVEYOR

*Robert D. Bagett*  
Attest: *J. L. Watson*